

# Drawer Front Adjustable Brackets

Bracket Positions (18mm carcass)

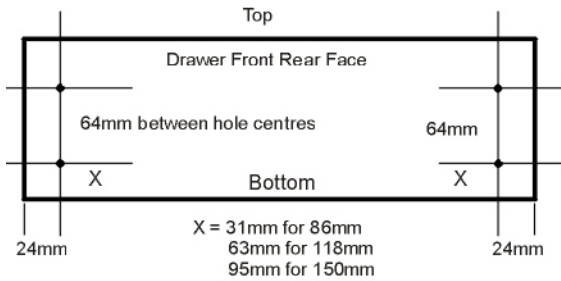

Bracket Positions (15mm carcass)

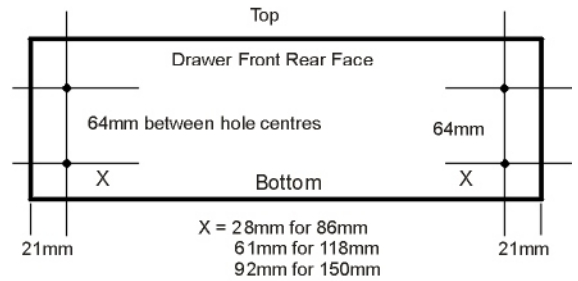

## Suggested MINIMUM Drawer Front Heights

- For 86mmH sides 126mm
- For 118mmH sides 156mm
- For 150mmH sides 187mm

# Drawer Runner Positions

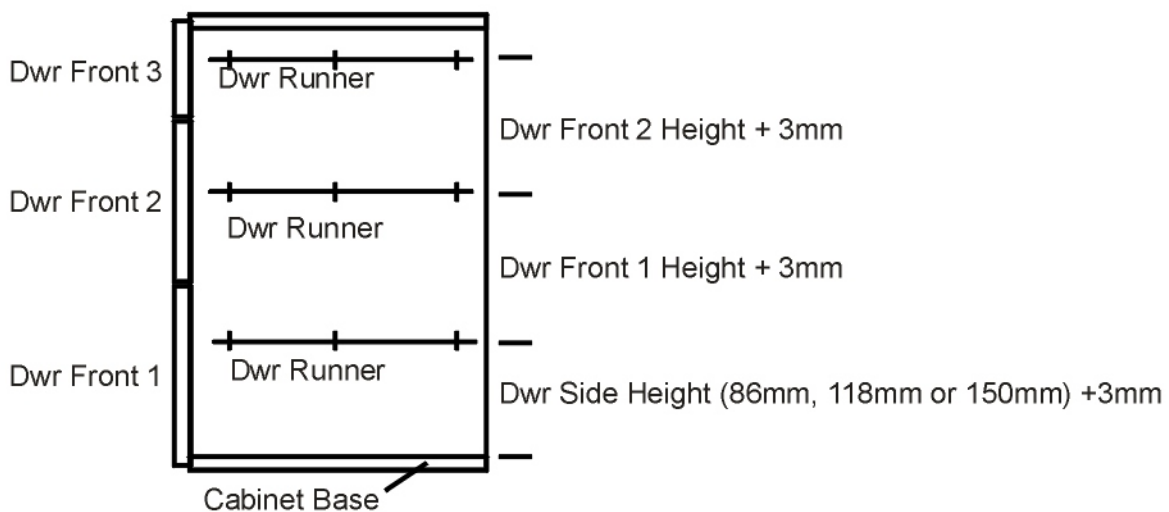

For cabinets with more than 3 drawers carry on same sequence as above.